

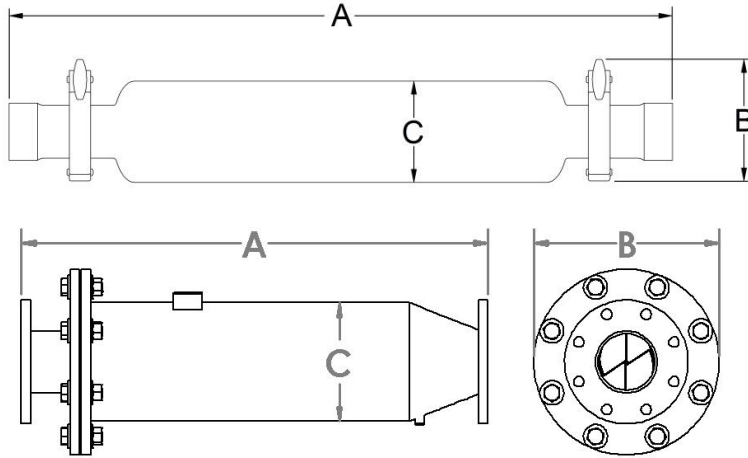

Water Conditioning for the 21st Century

Eco-Friendly – Uses No Chemicals – Maintenance Free – 5 Year Ltd. Warranty

SPECIFICATIONS FOR 1” – 16” INDUSTRIAL ECOFLOW



PART NO.	SIZE		(A) LENGTH		(B) MAX O.D.		(C) BODY O.D.		MAX FLOW RATE		WEIGHT	
	in	cm	in	cm	in	cm	in	cm	gpm	L/m	lbs.	kg.
EFR-0100-26	1	2.540	19-3/4	50.165	4-1/4	10.795	2-7/8	7.303	26	98.42	12.1	5.489
EFR-0200-52	2	5.080	22-1/2	57.150	4-1/2	11.430	3-1/2	8.890	52	196.84	18.3	8.301
EFA-0200-70	2	5.080	24	60.960	9	22.860	4-1/2	11.430	70	264.98	61.0	27.669
EFA-0200-100	2	5.080	24	60.960	10	25.400	5-9/16	14.129	100	378.54	72.0	32.659
EFA-0200-160	2	5.080	26	66.040	11	27.940	6-5/8	16.828	160	605.67	93.0	42.184
EFA-0250-160	2-1/2	6.350	26	66.040	11	27.940	6-5/8	16.828	160	605.67	96.0	43.545
EFA-0300-290	3	7.620	30	76.200	13-1/2	34.290	8-5/8	21.908	290	1,097.77	153.0	69.400
EFA-0400-416	4	10.160	34	86.360	13-1/2	34.290	8-5/8	21.908	416	1,574.73	164.0	74.389
EFA-0600-750	6	15.240	46	116.840	16	40.640	10-3/4	27.305	750	2,839.06	283.0	128.367
EFA-0800-1250	8	20.320	60	152.400	19	48.260	12-3/4	32.385	1,250	4,731.77	453.0	205.477
EFA-1000-1800	10	25.400	72	182.880	23-1/2	56.690	16	40.640	1,800	6,813.74	785.0	356.07
EFA-1200-2800	12	30.480	82	208.280	25	63.500	18	45.720	2,800	10,599.15	1,035.0	469.468
EFA-1400-3250	14	35.560	92	233.680	27-1/4	69.215	20	50.800	3,250	12,302.59	1,300.0	589.670
EFA-1600-4250	16	40.640	106	269.240	32	81.280	24	60.960	4,250	16,088.00	1,750.0	793.787

Common Unit Specifications

- **Pressure Loss** of 3 PSI or less for Each Unit.
- **Maximum Pressure Rating** of 150 PSI.
- Flow Rates Validated through the Center for Irrigation Technology, University of California, Fresno.
- Each unit is Hydrostatically Tested.

Materials of Construction

- **Body** is constructed of 304 Stainless Steel conforming to ASTM A778.
- **Flanged Connections** are 304 Stainless Steel Class D Flanges conforming to AWWA C228-08.
- **Interior Lining** is 32.oz Copper Sheet conforming to CDA 110, ASTM B152, AMS 4500, UNS C11000.
- **Hex Bolts** are Grade 5 per SAE J429.
- **Plated Hex Nuts and Flat Washers** are 18-8 Stainless Steel.

Due to our ongoing research and product development program the above mentioned specifications are subject to change without notice.

©2015 Morrill Industries, Inc.

24754 East River Road Escalon, CA 95320

Phone: (209) 838-2550 Fax: (209) 838-3544

Website: www.morrillinc.com and www.ecoflow.co

Rev-1.9.15

